

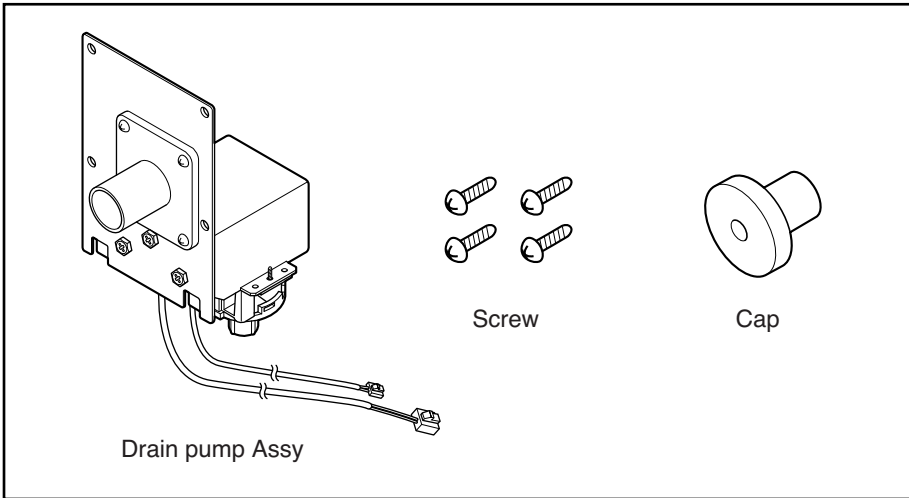

**Safety First**

- Cut off the power supply before installation and maintenance.
- Drain Pump Assy must be installed at safe area where it is far away from the user.
- Drain Pump Assy must be installed at appointed location.
- All wiring and connections are for installation only.



**Quantity**

<u>Quantity</u>	<u>Package contents</u>
1	Drain Pump Assy(AC220~240V, 50/60Hz, 400cm <sup>3</sup> /min)
4	Screw
1	Cap
1	Installation manual

**Service Parts List**

No.	Location No.	P/No.	Description	Remark
1	158590	5858A10001L	Pump Water	
2	266012	6601A20001E	Switch Assy, Float	

# How to install

---

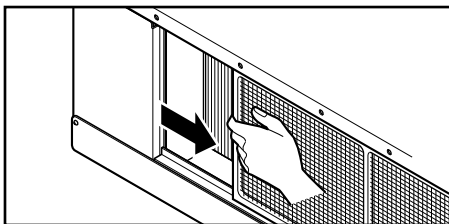

1. Remove the filter.

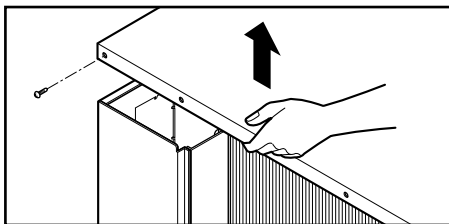

2. Open the top cover.

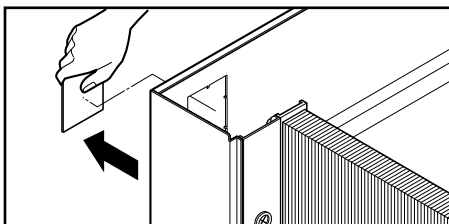

3. Remove the knock-out from the side panel.

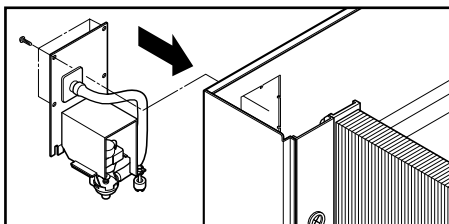

4. Assemble the drain pump assy.  
- Drive 4 screws to the Side Panel.

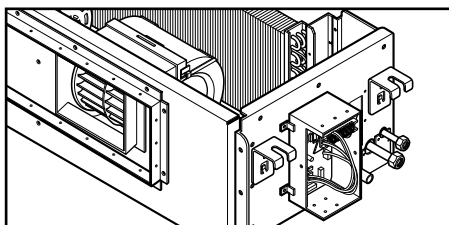

5. Connect two lead wires to control box.  
(One is for float switch, the other is for power supply to drain pump.)

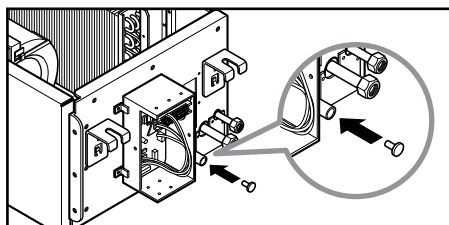

6. Close the drainage hole with the provided cap.

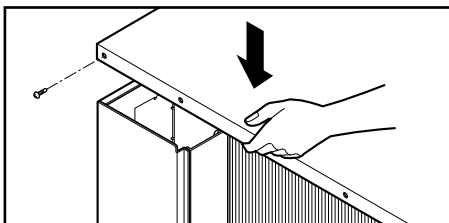

7. Assemble the top cover.

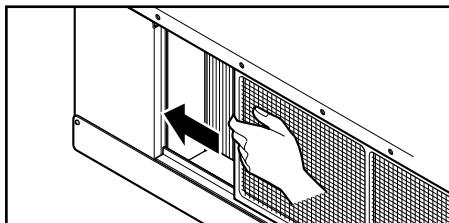

8. Insert the filter.

## Attention

1. Possible drain-head height is up to 700mm. So, it must be installed below 700mm.
2. Keep the drain hose downward up to 1/50~1/100 inclination. Prevent any upward flow or reverse flow in any part.

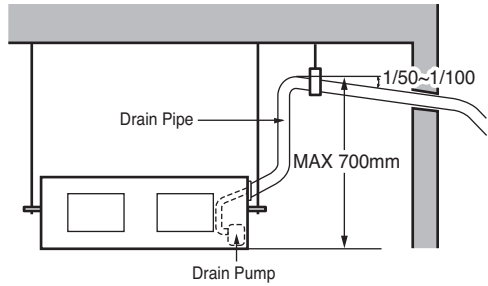

3. 5mm or thicker formed thermal insulator is provided for the drain pipe.

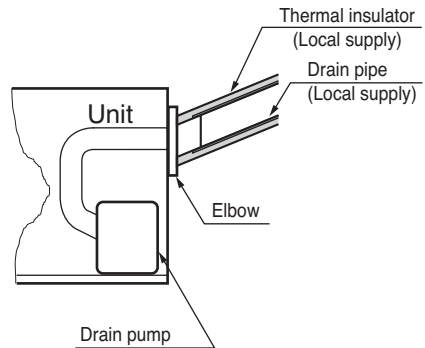

4. Upward routing is not allowed.
5. Be sure to check the drain pump for normal operation and abnormal noise when electrical wiring is complete.

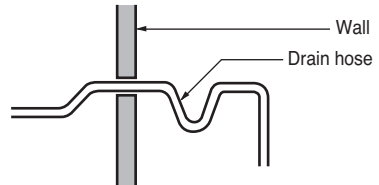

6. Be sure to be no water leakage after closing the drainage hole with a cap.

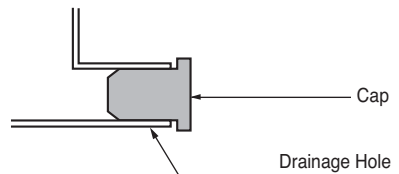

# Wiring Diagram

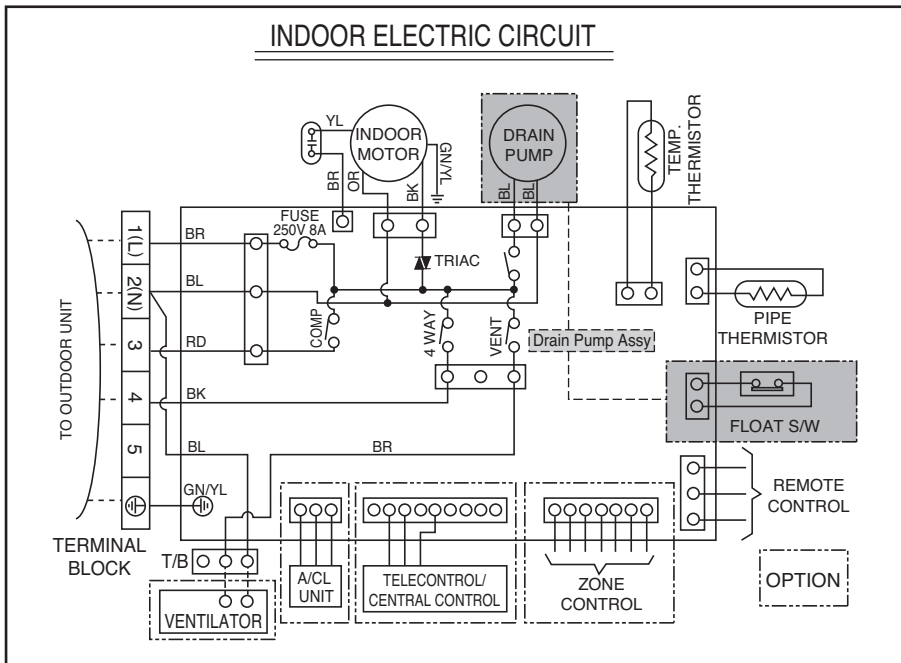

## Test operation

- Before test operation, be sure all information is understood completely, and follow the guideline of manual.
- Connect the power and turn on cooling mode.
- After compressor operating, it starts and compressor off, it stops 6 minutes later.

## Troubleshooting

PROBLEM	CAUSE	REMEDY
Pump does not work.	No power supply	Check electrical connection and voltage of the power supply.
	Float switch doesn't operate.	Check float switch.
Pump noisy	Pumping air	Check pump connection for water contamination.
	Vibrating against surfaces.	Check the assembly state of drain pump to the unit.