



Internal Use Only

<http://biz.lgservice.com>

Multi Air Conditioner

SVC MANUAL(Exploded View)

MODEL : AMNH05GTRA0
AMNH07GTRA0

CAUTION

Before Servicing the unit, read the safety precautions in General SVC manual.
Only for authorized service personnel.

1. Specification

Indoor

Indoor Unit Type			Free Joint Multi	
Model			AMNH05GTRAO	AMNH07GTRAO
Power Supply	Ø / V / Hz		1/220~240/50	1/220~240/50
Cooling Capacity	kW		1.47	2.05
	Btu/h		5,000	7,000
Heating Capacity	kW		1.67	2.34
	Btu/h		5,700	8,000
Current	Nominal Running Current	A	0.35	0.35
Fan	Motor Type		BLDC	BLDC
	Fan Type		Turbo Fan	Turbo Fan
	Motor Output(W) x No. of Unit		25*1	25*1
	Air Flow Rate (H / M / L)	CMM	7.5/6/5	7.5/6/5
		cfm	265/212/177	265/212/177
	External Static Pressure	mmAq	-	-
	Capacitor	µF / Vac	-	-
Drive		Direct Drive	Direct Drive	
Coil	Row x Column x FPI		1R x 8C x 18	1R x 8C x 18
Dimensions (W x H x D)	Body	mm(inch)	570*570*214(22.4*22.4*8.4)	570*570*214(22.4*22.4*8.4)
	Decorative Panel	mm(inch)	700*700*30(27.6*27.6*1.2)	700*700*30(27.6*27.6*1.2)
Net Weight	Body	kg (lbs)	13(28.7)	13(28.7)
	Decorative Panel	kg (lbs)	3(6.6)	3(6.6)
Air Filter			Long Life Filter	Long Life Filter
Sound Level (H / M / L)		dB(A)+3	31/27/23	31/27/23
Piping	Liquid	mm (inch)	6.35(1/4)	6.35(1/4)
Connections	Gas	mm (inch)	9.52(3/8)	9.52(3/8)
	Drain(OD/ID)	mm	32/25	32/25
Dehumidification Rate		l/h	1.1	1.1
Safety Devices			Fuse, Thermal Protector for Fan Motor	Fuse, Thermal Protector for Fan Motor
Temperature Sensor			Thermistor	Thermistor
Refrigerant			R410A	R410A
Refrigerant Control			EEV(in Outdoor Unit or BD Unit)	EEV(in Outdoor Unit or BD Unit)
Connectable Outdoor Unit			Multi F/FDX series	Multi F/FDX series
Power and Transmission Interunit Cable	No.x mm ²		4*0.75	4*0.75

Note:

- Capacities are based on the following conditions:
 Cooling: - Indoor Temperature 27°C(80.6°F) DB/19°C(66.2°F) WB
 - Outdoor Temperature 35°C(95°F) DB/24°C(75.2°F) WB
 Heating: - Indoor Temperature 20°C(68°F) DB/15°C(59°F) WB
 - Outdoor Temperature 7°C(44.6°F) DB/6°C(42.8°F) WB
 Piping Length - Interconnecting Piping Length 7.5m
 - Level Difference of Zero

- Wiring cable size must comply with the applicable local and national code.
- The specification may be subject to change without prior notice for purpose of improvement.

Conversion Formula
kW = Btu/h x 0.0002931
cfm = CMM x 35.3

2. Function Table

Category	Function	AMNH05GTRA0, AMNH07GTRA0 [MT06AH NR0], [MT08AH NR0]
Air flow	Air supply outlet	4
	Airflow direction control (left & right)	X
	Airflow direction control (up & down)	Auto
	Auto swing (left & right)	X
	Auto swing (up & down)	O
	Airflow steps(Fan / Cool / Heat)	4/5/4
	CHAOS swing	X
	CHAOS wind (Auto wind)	O
	Jet cool/Jet heat (Power wind)	O/X
Air purifying	Swirl wind	O
	Deodorizing filter	X
	Allergy free filter	X
	Plasma air purifier	PTPKQ0
Installation	Prefilter(Washable / Anti-fungus)	O
	Drain pump	O
	E.S.P. control	-
	Electric heater (Operation)	-
Reliability	High ceiling operation	O
	Hot start	O
	Self diagnosis	O
Convenience	Soft dry operation	O
	Auto changeover	X
	Auto cleaning	X
	Auto elevation Grille	X
	Auto operation(Artificial intelligence)	O
	Auto restart operation	O
	Child lock	O
	Forced operation	O
	Group control	O*
	Sleep mode	O
	Timer (On/Off)	O
Individual Control	Timer (weekly)	O
	Two thermistor control	O
	Standard wired remote controller	PQRCVSL0 / PQRCVSL0QW
	Wide wired remote controller	O
	Deluxe wired remote controller	PQRCUDS0
	Simple wired remote controller	PQRCUCS0C
	Wired remote controller(for hotel use)	PQRCFCS0C
	Wireless remote controller(simple)	AHWRHS
Wireless Ez remote controller	PQWRHDF0	
CAC Network Function	Wireless LCD remote control	PQWRHSF0
	General central control(Non LGAP)	X
	Dry contact	PQDSB
	Dry contact(temperature setting)	PQDSBC
	Central control(LGAP)	O
	PDI(Power Distribution Indicator)	PQNUD1S00
Special Function Kit	PI 485	PMNFP14A0
	CTIE	X
Others	Zone control	X
	Remote temperature sensor	PQRSTA0

* PDI(power distribution indicator) & PI 485 are installed outdoor unit.

Note :

O : Applied, X : Not applied, - : No relation

* Option : Model name & price are different according to options, and assembled in factory with main unit.

* Accessory : Installed at field, ordered and purchased separately by the corresponding model name, supplied with separate package.

3. Piping Diagrams

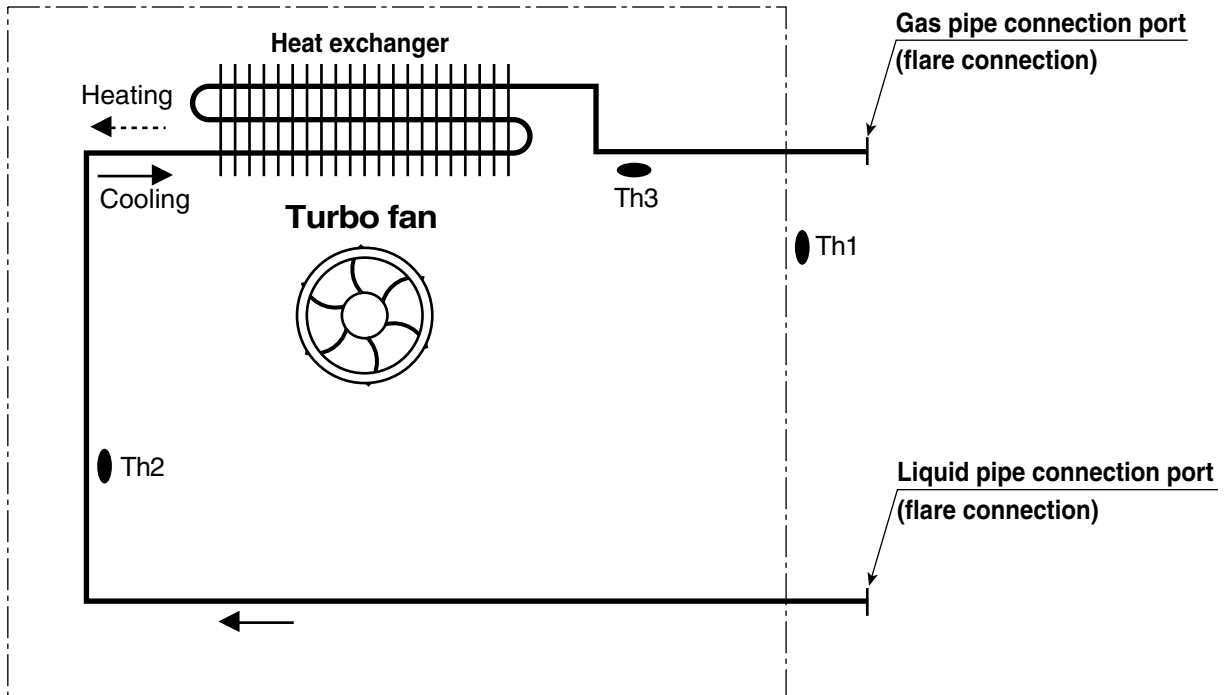

LOC.	Description	PCB Connector
Th1	Thermistor for suction air temperature	CN-TH1(Indoor)
Th2	Thermistor for evaporator inlet temperature	
Th3	Thermistor for evaporator outlet temperature	CN-TH2(Indoor)

4. Wiring Diagrams

Indoor Unit

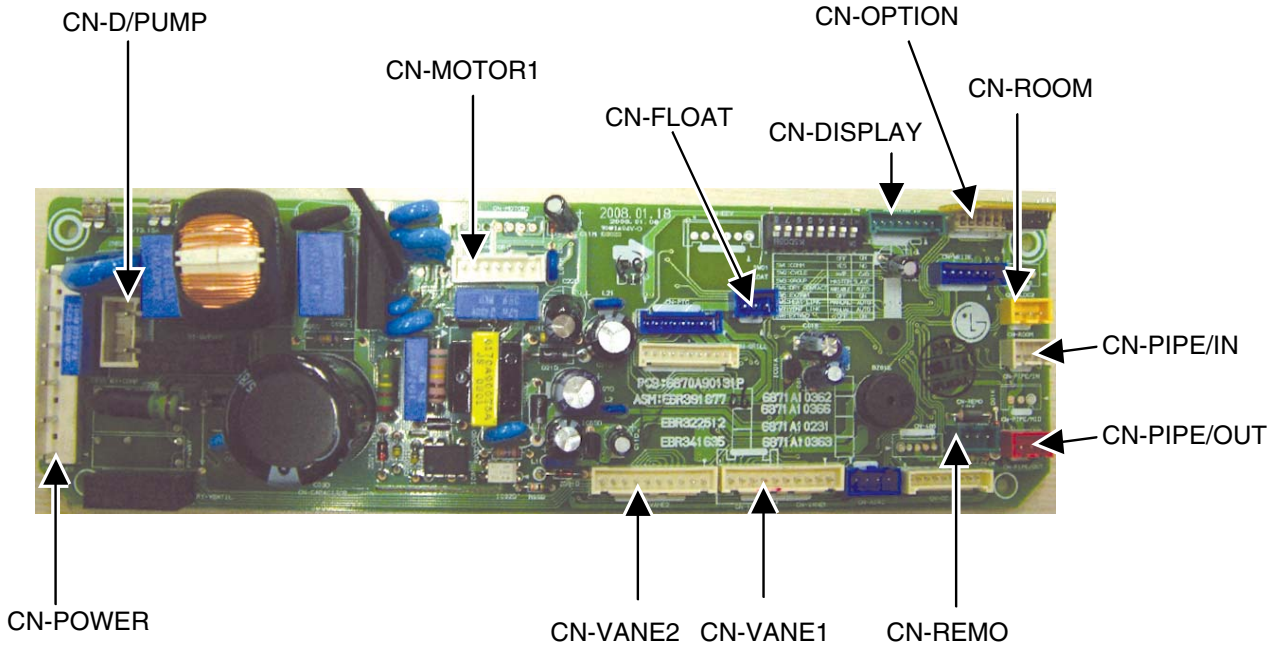
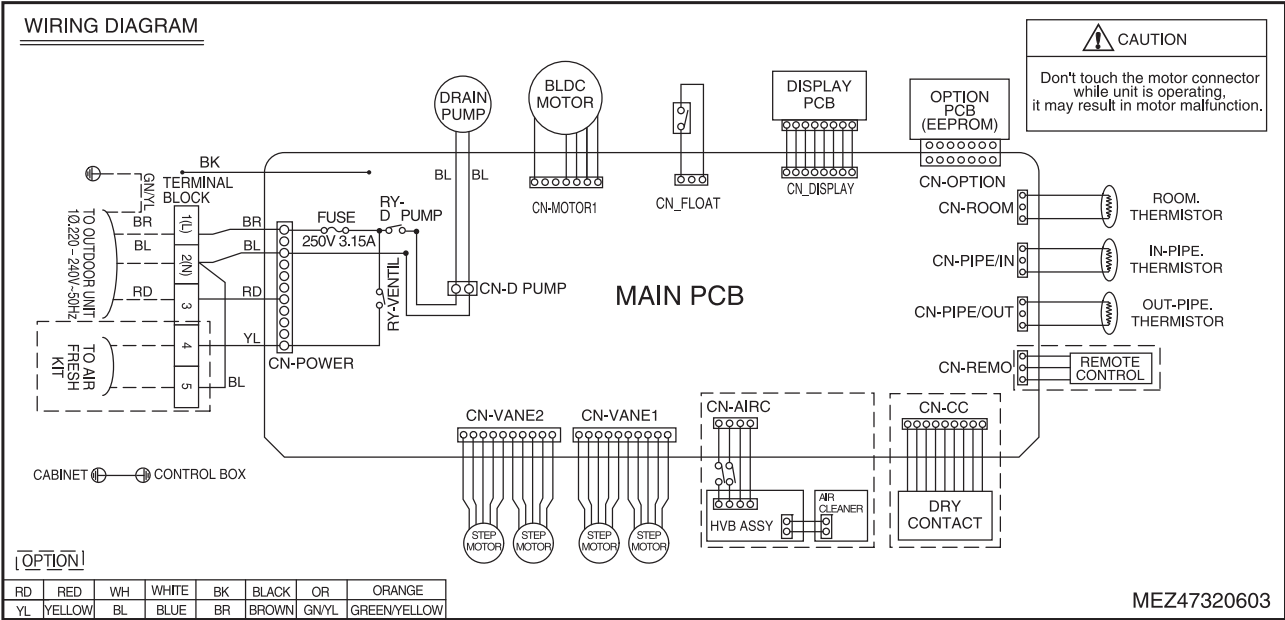

5. Exploded View

Indoor Unit

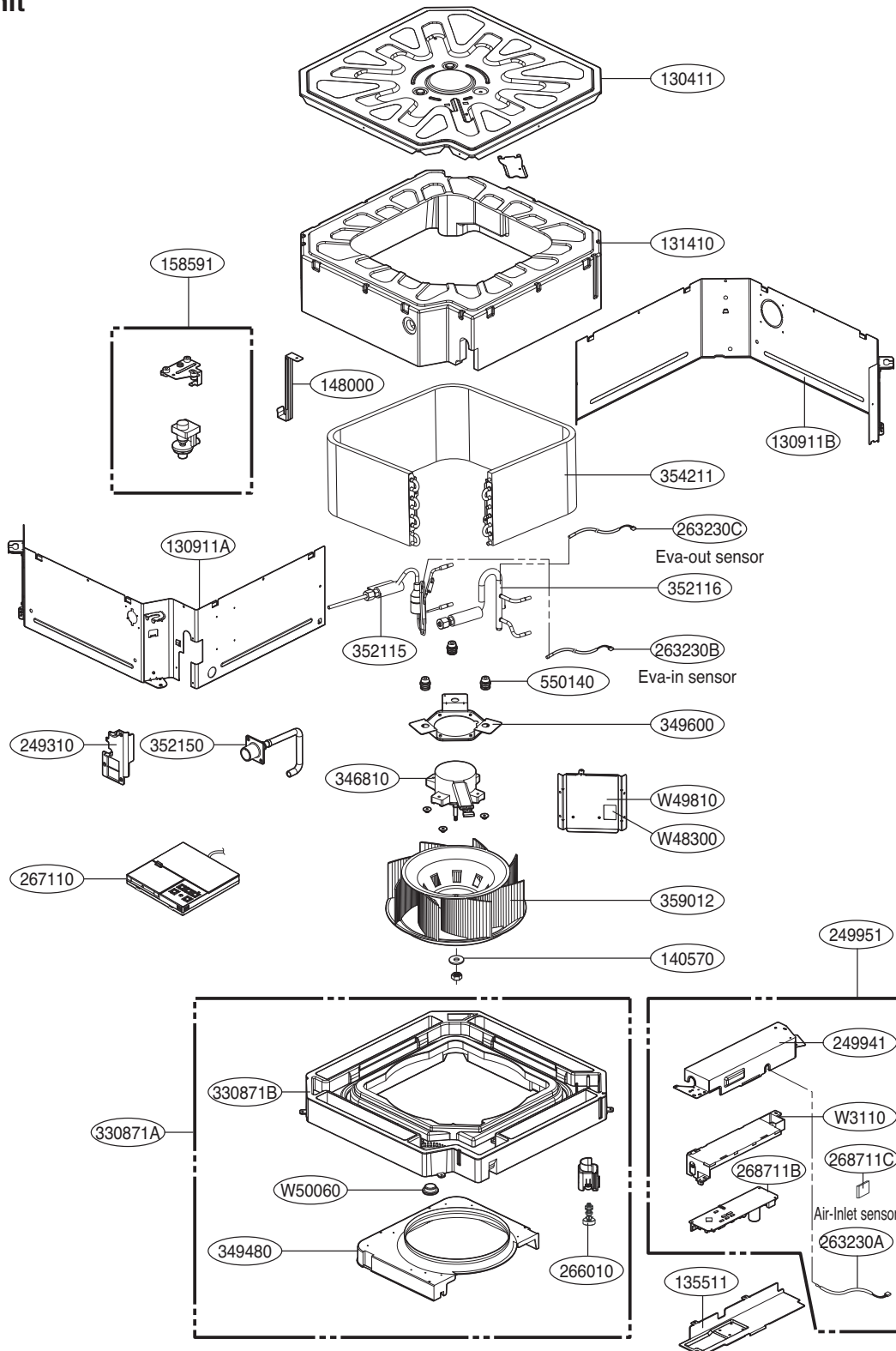

Note) * Please ensure GCSC since the replacement parts may be changed depending upon the buyer's request.
Please check the correct parts in View RPL(Replacement Part List) on GCSC.
(GCSC Website <http://biz.lgservice.com>,)

Front Panel (Accessory)

• Model : PT-UQC

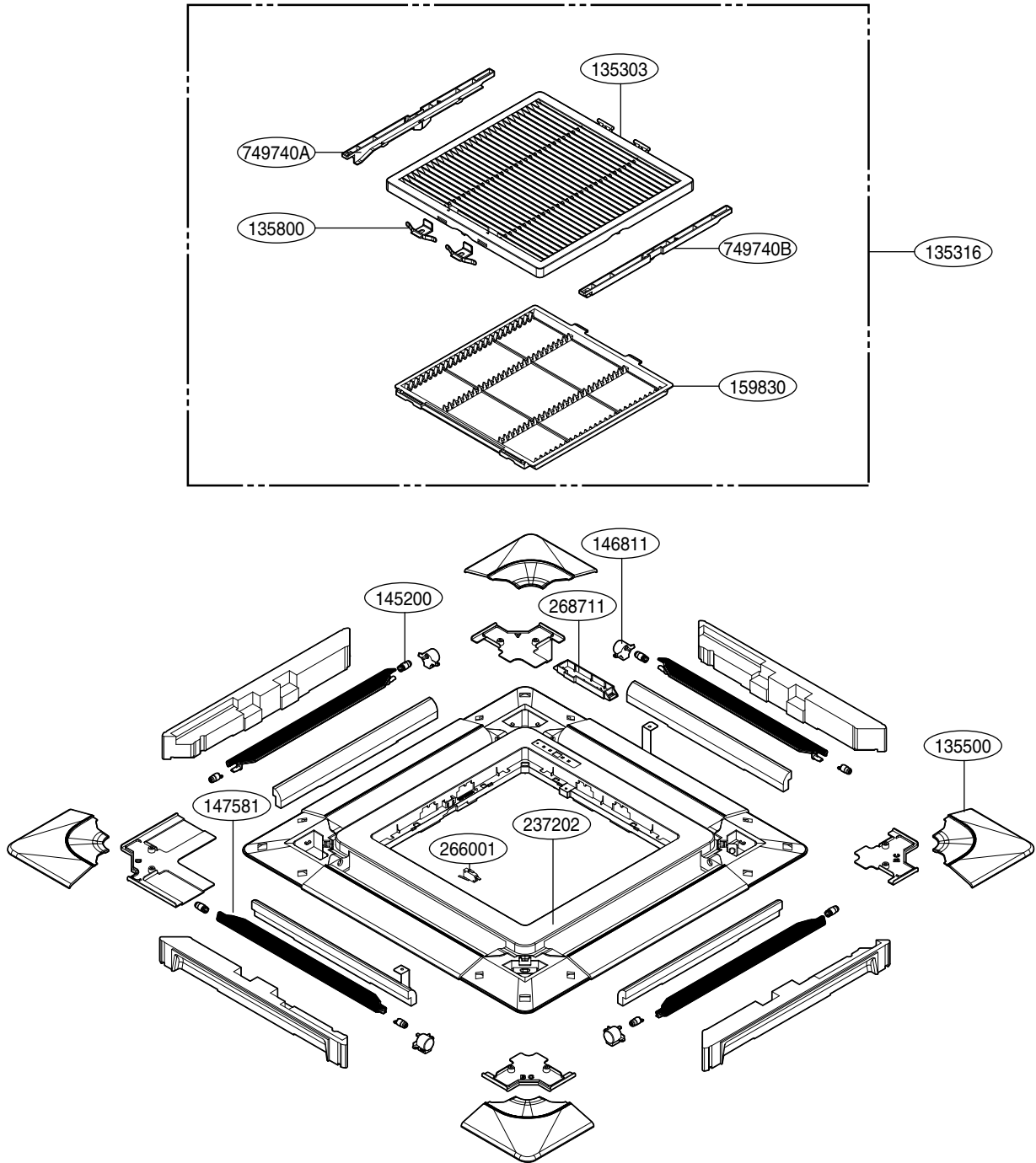

Note) * Please ensure GCSC since the replacement parts may be changed depending upon the buyer's request.
Please check the correct parts in View RPL(Replacement Part List) on GCSC.
(GCSC Website <http://biz.Lgservice.com>.)



P/NO : MFL48188405

NOVEMBER, 2009